

RCP2-BA6

Robo Cylinder Slider-Belt Type, Slider Width 58mm, Pulse Motor, Motor on Top

RCP2-BA6U

Robo Cylinder Slider-Belt Type, Slider Width 58mm, Pulse Motor, Motor Underneath

Type / Slider (58mm wide)

Stroke / 500 ~ 1000mm

Load capacity / 4 kg (horizontal)

Model Specification Items Series — Type — Encoder type — Motor output — Lead — Stroke — Applicable controller — Cable length — Option
 (Example) : RCP2 — BA6□ — □ A□ — □ PM□ — □ 4□ — □ 00□ — □ P1□ — □ S□ — □ NM

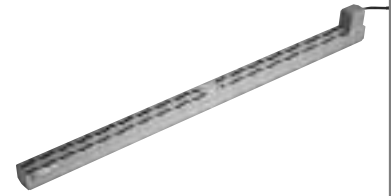

Models/Specifications

* The maximum speed of the RCP2 series will vary according to the weight of the load installed on the slider (or rod). Refer to the diagram on the back cover for the relationship of speed and load capacity.

| Model | Encoder type | Motor type | Lead (mm) | Stroke (50mm increments) (mm) | Speed (mm/s) | Load capacity (kg) (Note 1) | | Motor position |
|---|----------------|-------------|------------------|-------------------------------|--------------|-----------------------------|---------------|----------------|
| | | | | | | Horizontal (kg) | Vertical (kg) | |
| RCP2-BA6- 1 -PM-54- 2 -P1- 3 - 4 | A: Absolute | Pulse motor | Equivalent to 54 | 500 ~ 1000 | 100 ~ 1000 | 4 ~ 2 | — | Top |
| RCP2-BA6U- 1 -PM-54- 2 -P1- 3 - 4 | I: Incremental | | | | | | — | Underneath |

* In the above model names, **1** indicates the encoder type, **2** the stroke, **3** the cable length, and **4** the applicable options.

Option

| Name | Type | Reference Page |
|-----------------------------|------|----------------|
| Reversed-home specification | NM | — |

Common Specifications

| | |
|----------------------------------|--|
| Drive method□ | Timing belt |
| Positioning repeatability□ | ±0.1mm |
| Backlash□ | 0.1mm or less |
| Guide□ | Integrated with base |
| Allowable load moment (Note 2) | Ma: 8.9N · m Mb: 12.7N · m Mc: 18.6N · m |
| Overhung load length□ | Ma, Mb, Mc: 150mm or less |
| Base□ | Material: Aluminum with white alumite treatment |
| Cable length (Note 3)□ | N: No cable, S: 3m, M: 5m, X□□: Specified length |
| □ | □: Robot cable |
| Operating temperature, humidity□ | 0 ~ 40°C, 85%RH or below (non-condensing) |

Dimensions

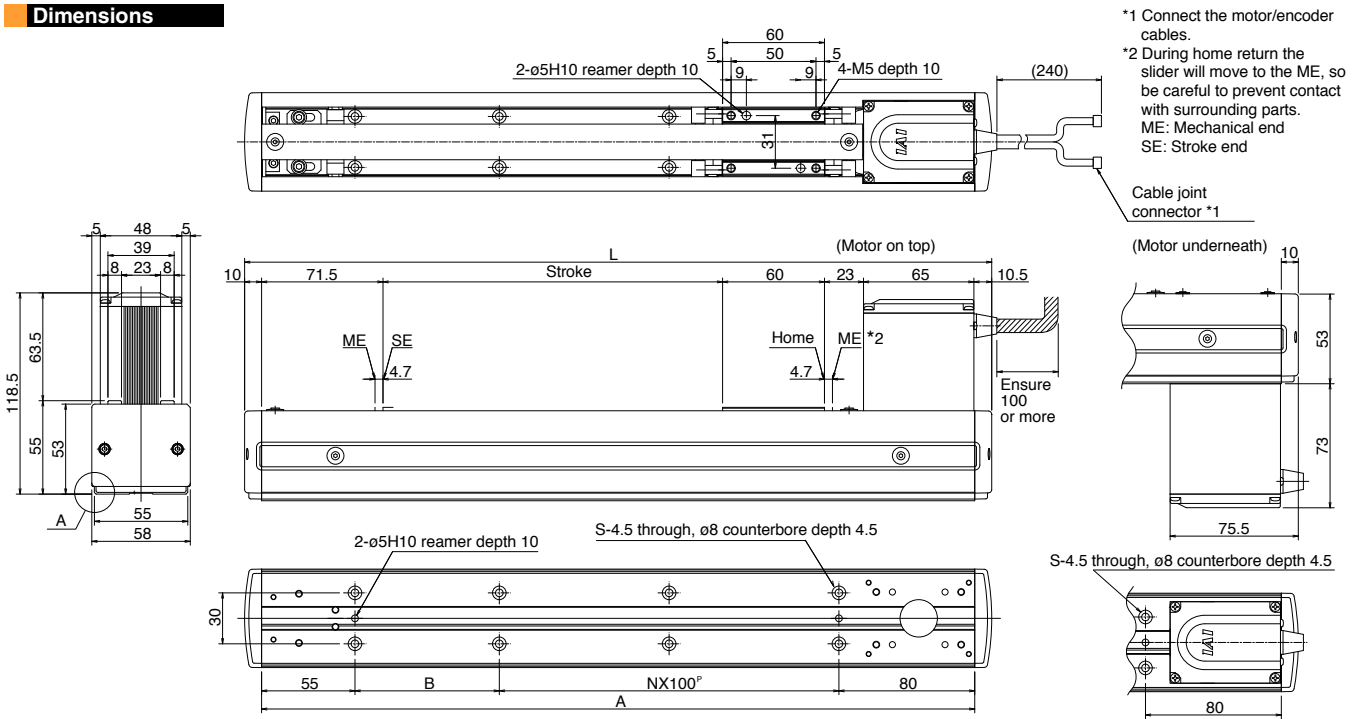

Dimensions and Weight by Stroke

| Stroke | 500 | 550 | 600 | 650 | 700 | 750 | 800 | 850 | 900 | 950 | 1000 |
|------------|-----|-----|-----|-----|-----|-----|------|------|------|------|------|
| L | 740 | 790 | 840 | 890 | 940 | 990 | 1040 | 1090 | 1140 | 1190 | 1240 |
| A | 720 | 770 | 820 | 870 | 920 | 970 | 1020 | 1070 | 1120 | 1170 | 1220 |
| B | 85 | 35 | 85 | 35 | 85 | 35 | 85 | 35 | 85 | 35 | 85 |
| N | 5 | 6 | 6 | 7 | 7 | 8 | 8 | 9 | 9 | 10 | 10 |
| S | 14 | 16 | 16 | 18 | 18 | 20 | 20 | 22 | 22 | 24 | 24 |
| Weight(kg) | 2.8 | 2.9 | 3.0 | 3.2 | 3.3 | 3.4 | 3.5 | 3.7 | 3.8 | 3.9 | 4.1 |

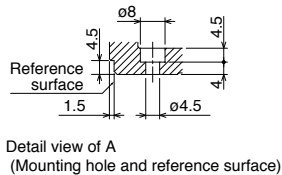

Applicable Controller Specifications

| Applicable controller | Maximum number of controlled axes | Compatible encoder type | Operating method | Power supply voltage |
|-----------------------|-----------------------------------|-------------------------|------------------|----------------------|
| RCP2-C | 1 axis | Absolute/incremental | Positioner | DC24V |
| RCP2-CG | 1 axis | | | |



(Note 1) Based on an acceleration of 0.5 G. Due to the structure of the product, vertical transfer applications are not supported.
 (Note 2) Based on a traveling life of 5,000 km.
 (Note 3) The maximum cable length is 15 m for the absolute type and 20 m for the incremental type. Specify the desired length in meters (ex. X08 = 8 m).

RCP2 New Product Lines